

www.cift.res.in
Phone: 0484-2412300
Fax: 0091 -484-2668212

E.Mail: cift@ciftmail.org
ciftpurchase@gmail.com



केन्द्रीय मात्स्यकी प्रौद्योगिकी संस्थान
CENTRAL INSTITUTE OF FISHERIES TECHNOLOGY
(भारतीय कृषि अनुसन्धान परिषद)
(INDIAN COUNCIL OF AGRICULTURAL RESEARCH)
विल्लिंगडन आइलैंड, मत्स्यपुरी पी. ओ., कोच्चिन-682 029
WILLINGDON ISLAND, MATSYAPURI P.O., COCHIN-682 029



***TENDER FOR THE SUPPLY OF
FURNITURE FOR PROCESSING & BYPRODUCTS
LABORATORIES OF
CIFT -KOCHI***

Tender Enquiry No.: [**F.No. 7-2/2020-Purchase**](#)

Click above to view in CPP portal

email: ciftpurchase@gmail.com

website: www.cift.res.in

www.eprocure.gov.in

Tel: 0484 – 2412397 / 2412345

INDEX

S. No.	Description	Page No.
1	Notice inviting tender	3
2	Instructions to tenderers	4-5
3	General Terms & conditions	6-8
4	Specification of the Equipment/Goods (Annexure I)	9-10
5	Online Bid submission details	11

www.cift.res.in

Phone: 0484-2412300

Fax: 0091 -484-2668212

E.Mail: cift@ciftmail.org

ciftpurchase@gmail.com



केन्द्रीय मात्स्यकी प्रौद्योगिकी संस्थान
CENTRAL INSTITUTE OF FISHERIES TECHNOLOGY
(भारतीय कृषि अनुसन्धान परिषद)
(INDIAN COUNCIL OF AGRICULTURAL RESEARCH)
विल्लिंगडन आइलैंड, मत्स्यपुरी पो. ओ., कोच्चिन-682 029
WILLINGDON ISLAND, MATSYAPURI P.O., COCHIN-682 029



NOTICE INVITING TENDER

CIFT invites e-tenders for the supply of Furniture for Processing & by Products Laboratories through the website www.eprocure.gov.in under two bid system from reputed manufacturers / suppliers.

Tender Enquiry No. : F. No. 7-2/2020-Purchase	
Published Date	13.01.2021 - 1700 hrs
Pre Bid Meeting	20.01.2021- 11 00 hrs
Bid submission start date	20.01.2021- 14 30 hrs
Bid submission end date	03.02.2021 - 1100 hrs
Technical bid opening date	04.02.2021 - 1130 hrs

IMPORTANT NOTES:-

1. Tender Documents can be downloaded from CIFT website www.cift.res.in or from the Central Public Procurement Portal www.eprocure.gov.in. Bidders should enroll / register in the e-procurement module of Central Public Procurement Portal through the website : www.eprocure.gov.in for participating in the bidding process. Bidders should also possess a valid DSC for online submission of bids.
2. **Bids received on e-tendering portal only will be considered. Bids in any other form sent through sealed cover/email/post/fax etc. will be rejected.**
3. Director, CIFT, Cochin -6802029 reserves the right to accept / reject any or all the tenders in part /full without assigning any reason in the best advantage of this Institute.
4. CIFT will not be responsible for any delay in enrollment / registration as bidder or submitting uploading the offer on e-tender portal. Hence, bidders are advised to register in e-tendering website www.eprocure.gov.in and enroll their Digital Signature Certificate and upload their quotation well in advance.
5. Any change / corrigendum/ extension of opening date in respect of this tender shall be issued through websites only and no press notification will be issued in this regard. Bidders are therefore requested to regularly visit our website for updates.

Asst. Admn. Officer (P)
FOR DIRECTOR

Place: Kochi

Date: 13.01.2021



केन्द्रीय मात्स्यकी प्रौद्योगिकी संस्थान
CENTRAL INSTITUTE OF FISHERIES TECHNOLOGY
(भारतीय कृषि अनुसन्धान परिषद)
(INDIAN COUNCIL OF AGRICULTURAL RESEARCH)
विल्लिंगडन आइलैंड, मत्स्यपुरी पी. ओ., कोच्चिन-682 029
WILLINGDON ISLAND, MATSYAPURI P.O., COCHIN-682 029



INSTRUCTIONS TO THE TENDERERS

The tender shall be submitted in accordance with these instructions and any tender not confirming to the instructions as under is liable to be rejected. These instructions shall form the part of the tender and the contract.

1. For Online Bid Submission, as per the directives of Department of Expenditure, this tender document has been published on the Central Public Procurement Portal ([URL:http://eprocure.gov.in/eprocure/app](http://eprocure.gov.in/eprocure/app)). The bidders are required to submit soft copies of their bids electronically on the CPP Portal, using valid Digital Signature Certificates.

More information useful for submitting the online bids on the CPP Portal is available at [“Bidders Manual Kit”](#)

For Registration

2. Bidders are required to enroll on the e-Procurement module of the Central Public Procurement Portal ([URL:http://eprocure.gov.in/eprocure/app](http://eprocure.gov.in/eprocure/app)) by clicking on the link [“Online Bidder Enrollment”](#). Enrollment on the CPP Portal is free of charge.
3. The intending Tenderer, in case of Prime Equipment Manufacturers (PEM) shall upload a self-declaration on their letter-head as PDF file in Cover-I of e-tender, along with the tender documents, confirming that they are regularly manufacturing, supplying, installing, testing & commissioning of the similar equipment for the last 2 years.
4. The intending Tenderer, in case of Authorized Distributor/ Authorised Dealer shall possess valid authorized Distributorship /Dealership license from Prime Equipment Manufacturers (PEM). The tenderer shall enclose the copy of the same as PDF file in Cover-I of the e-tender while submitting the tender.
5. The equipment shall be in compliance with the specifications mentioned in Annexure - I of the tender and shall be of the latest technology, best quality and high standards.
6. Any optional accessories / tooling, besides the standard equipment recommended for the better performance of the equipment, if offered, be provided with their full technical details including their use and advantage in a separate sheet with the tender documents. **Minimum 1year guarantee has to be provided for the equipment.**
7. No extra payment shall be paid on account of any discrepancy in nomenclature of items.

8. While submitting the tender, if any of the prescribed conditions are not fulfilled or are incomplete in any form, the tender is liable to be rejected. If any tenderer stipulates any condition of his own, such conditional tender is liable to be rejected.
9. Director, CIFT, reserves the right to reject any tender/bid wholly or partly without assigning any reason in the best advantage of this Institute.
10. The Technical Committee constituted by the Director, CIFT shall have the right to verify the particulars furnished by the bidder independently.
11. Tenderer shall take into account all costs including installation, commissioning, cartage etc. for giving delivery of material at site **i.e. CIFT, Cochin** before quoting the rates. In this regard no claim for any extra payment for any reason shall be entertained.
12. The item should be delivered at **CIFT, CIFT Junction, Matsyapuri P.O, Cochin – 682029** and the supplier shall be responsible for dues any damage during the transit of goods.
13. All the tender documents & price bid to be uploaded as per this tender are to be digitally signed by the bidder.
14. All the communications with respect to the tender shall be addressed to:

**The Director,
Central Institute of Fisheries Technology,
Willingdon Island, Matsyapuri P.O.
Kochi – 682029.**



केन्द्रीय मात्स्यकी प्रौद्योगिकी संस्थान
CENTRAL INSTITUTE OF FISHERIES TECHNOLOGY
(भारतीय कृषि अनुसन्धान परिषद)
(INDIAN COUNCIL OF AGRICULTURAL RESEARCH)
विल्लिंगडन आइलैंड, मत्स्यपुरी पी. ओ., कोच्चिन-682 029
WILLINGDON ISLAND, MATSYAPURI P.O., COCHIN-682 029



GENERAL TERMS & CONDITIONS

1. Name of the Item : **Furniture for Processing & By products laboratories**
2. Quantity : **1 No.**
3. Only bids received on CPP Portal will be considered for opening. Bids in any physical form sent through fax/email/courier/post/ delivered personally will not be considered.
4. Bidder should log into the site well in advance for bid submission so that the bid is uploaded in time i.e. on or before the bid submission time. Bidder will be responsible for any delay due to other issues.
5. The bidder has to digitally sign and upload the required bid documents one by one as indicated in the tender document.
6. The rates quoted should be for delivery and installation at **CIFT, Cochin**. The tender shall be valid for a period of 90 days from the date of opening of the tender. **If taxes, duties or any other charges over and above the rates quoted are payable by the purchaser actuals of such taxes/duties/charges should be clearly indicated in the financial bid (BOQ). Please note that this Institute is entitled to 5% concessional GST, exempted from payment of excise duty as applicable to Educational / Research Institutions/ Laboratories etc. against declaration form.**
7. The equipments offered shall confirm to the specifications as given in Annexure -I/supply order and shall be guaranteed against defective design, defective quality material supplied, manufacturing defects etc., for a minimum period of 3 years from the date of supply. Documents supporting the technical specification of the quoted goods may be uploaded in Cover - I in the PDF format.
8. The Tenderer shall upload PDF format copy of GST Registration/ Income Tax PAN, in Cover - I of the e-tender.
9. Bid Security : Bod Security Declaration should be kept in the Bid Documents
10. **Performance Security:** The successful Firm/Party is required to remit a performance security amounting to 3% of the cost of the item/equipment in the form of Demand Draft /Bankers cheques drawn in favour of "ICAR Unit CIFT, Cochin "payable at State Bank of India, Willingdon Island Cochin-682029 or Bank Guarantee from a commercial Bank as directed by this office. The performance security to be remitted within 10 days from the formal intimation. If the bidder fails to remit the Performance Security the Bid security will be forfeited and the acceptance of the tender will be withdrawn and no further correspondence in this regard will be entertained.
11. **Full specification of the article quoted, shall be uploaded , in the e-tender in PDF form along with illustrated pamphlets, drawings etc., wherever applicable in Cover – 1.**

12. Parties may visit our laboratories for understanding layouts and measurements.

13. Payment will be made by Bank/Electronic Transfer, only after satisfactory completion of supply/installation and receipt of pre-receipted bill in triplicate. Quotations giving any other mode of payment may be avoided.
14. The Director, C.I.F.T., COCHIN-682029 reserves the right to accept or reject any or all the quotations either in full or in part without assigning any reason in the best advantage of this Institute. Director CIFT, reserves the right to increase /decreases the quantity of units depending upon the actual requirement arising at the time of award of contract.
15. Proper servicing, whenever necessary, has to be provided by the supplier or their authorized agents. Availability of technical support & servicing facility locally/nationally should be submitted in pdf form in Cover-1 .
16. .Users list may also to be attached in the tender form in cover-1

Laboratory furniture for Chemical Labs in Fish Processing Division

CHEMICAL LAB -01

Island Bench 3000 mm - 2 Nos

18 (\pm 1)mm thick granite worktop 1500 mm wide with plybacking

u/b storage cabinet with 1 adjustable shelf 600mm wide & 1 door with lock

u/b sink cabinet cum storage 1360mm wide with lock

u/b cabinet with 1 drawer, 1 adj. shelf & 1 door 600mm wide with lock

front+back frame

Filler panel

side frames

knee space panel

bench mounted eye wash

cold water standout with triple outlets

15 Amp/220 Volt double electrical outlet

polypropylene sink 450x350 mm

two tier reagent rack 300mm wide

service box

reagent rack pillar

Floor Mounted Emergency Shower - 01 No.

floor mounted emergency shower with eye wash

Tasting booth with required lighting facility - with 6 cabins

CHEMICAL LAB -02 BYPRODUCTS LAB

Island Bench 3000 mm - 2 Nos

18 (\pm 1)mm thick granite worktop 1500 mm wide with plybacking

u/b storage cabinet with 1 adjustable shelf 600mm wide & 1 door with lock

u/b sink cabinet cum storage 1360mm wide with lock

u/b cabinet with 1 drawer, 1 adj. shelf & 1 door 600mm wide with lock

front+back frame

Filler panel

side frames

knee space panel

bench mounted eye wash

cold water standout with triple outlets

15 Amp/220 Volt double electrical outlet

polypropylene sink 450x350 mm

two tier reagent rack 300mm wide

service box

reagent rack pillar

Floor Mounted Emergency Shower - 1 No
floor mounted emergency shower with eye wash
Fume Cupboard - 1 No
fume cupboard 1825mm wide services are electrical
Chemical Storage - 1 No
chemical storage cabinet size:800x400x1500mm(h)

OFFICE ROOM - CHEMICAL LAB

WALL BENCH - 3000 mm(750MM HEIGHT FROM F.F.L) - 1 No
18 (\pm 1)mm thick granite worktop 600 mm wide with backsplash & plybacking
u/b storage cabinet with 1 adjustable shelf & 1 door 600mm wide
u/b cabinet with 1 drawer, 1 adj. shelf & 1 door 600mm wide with lock
front+back frame
Filler panel
side frames
knee space panel
WALL CABINETS - 1 No
wall cabinet with 2 panel doors 1200mm wide with lock

INSTRUMENT ROOM

Wall Bench - 1800 mm(750MM HEIGHT FROM F.F.L) - 1 No
18 (\pm 1)mm thick granite worktop 750mm wide with plybacking
u/b cabinet with 2 drawer & 2 door 600mm wide with lock
front+back frame
side frames
Wall Bench - 1500 mm(750MM HEIGHT FROM F.F.L) 5 Nos
18 (\pm 1)mm thick granite worktop 750mm wide with plybacking
u/b cabinet with 1 drawer, 1 adj. shelf & 1 door 600mm wide with lock
front+back frame
side frames
PU Laboratory Chairs - 1 No
Tall Storage - 1 No
Balance bench - 1 No

SPECIFICATIONS OF MATERIALS FOR CHEMICAL LAB IV, BYPRODUCTS LABORATORY & INSTRUMENT ROOM

1. WORKTOPS

1.1 GRANITE

The table work tops where specified shall be of at least 18 mm thick Jet Black colour Granite (min 7 to 8 Kg Sq. Ft) of even surface, fine to close-grained, with equi-granular crystalline texture, without any undue specks, or cracks and should not have any epoxy coating and grooved at bottom to avoid spillage on modular storage. The edges of the granite tops shall be half round molded and polished. The granite top shall be with minimum 16mm thick plywood backing. Where specified, The work benches to be provided with 100mm back splash of above granite material with half round edge moulding to be fixed on the wall side (with minimum joints) and all joints shall be done neatly and aesthetically.

The Size and layout is described in the specific requirement table

2. UNDERBENCH CABINETS / TALL STORAGES/WALL CABINETS

- 2.1 The Carcass/ Cabinet Body/ Shutters/ Door/ Drawer Front/ Shelves/ Trays/ Table Work Top/ Filler Panel/ Corner Support Panels etc. shall be constructed from min. 16 mm thick (BWP – Boiled Water Proof). Plywood. The above shall be laminated with min. 0.8 mm thick High Pressure Melamine Laminate of high quality. The exposed edges shall be sealed with min. 0.5 mm thick high quality PVC edge tapes. The lamination and edging shall be machine pressed at high temperature and pressure.
- 2.2 The edges of the doors/ drawers/ worktop etc. shall be sealed with min. 3mm thick high quality PVC edges. The lamination and edging shall be machine pressed at high temperature and pressure.
- 2.3 Knee space Panel shall be made of 9 mm thick and Back wall of storages shall be made of 4mm thick BWP Melamine laminated plywood.
- 2.4 For High Strength and Durability, Permanent case work shall be made using latest technology such as biscuit joints with necessary adhesives. The joinery construction with biscuit type joints, shall be clamped to perfect alignment. The Cabinet body shall be made of permanent casework without any screws and knockdown / mini-fix fittings (mini fix and dowel joints not accepted). There should not be gaps anywhere for dust accumulation Inside of the cabinet body. All joints shall be sealed and it shall be easily cleanable.
- 2.5 Doors of all under bench Storages/Overhead storage should have smooth anodized aluminum grab rails powder coated with Minimum 80 microns.
- 2.6 The Doors of the Tall storage cabinets (if any) shall be Stainless Steel D type handles.

- 2.7 There shall be minimum of three heavy duty nickel plated heavy duty, self-closing concealed hinges for each cabinet door and should open 165 degree and shall be with 3-way adjustment for perfect finish and correct alignment. Door hinges shall be of International make, Hettich, Hafele, Ebco , Blum or Equivalent.
- 2.8 Standard Drawer slides shall be meta box type, made of metal, epoxy coated and with nylon wheels to allow smooth and silent sliding.
- 2.9 The size and layout for station and storages are described in the specific requirement table. Storages have drawers as well as doors in different sizes. Where specified good quality locks and keys to be provided for cabinets/tall storages.
Colour of laminates, edging, and grab rails to be fixed after the discussion with CIFT staff.

3. PREPERATION/STORAGE SUPPORT FRAME WORK

- 3.2 The worktops are supported by 'H' frames in some instances. These standard H frames support shall be made of min. 2mm thickness 30 x 30 mm square tube sections which are welded. Front and back frames shall be provided for connecting all the 'H' frames, supporting complete bench. Worktops and all u/b cabinetry sink units etc. shall be supported by this frame work.
The frame work shall be de – greased and polyester epoxy powder with a dry film thickness of min. 80 microns for smooth finish and protection.
Adjustable leveling jacks of tough plastic/nylon shall be provided for each leg for the support of the frame.

4. Polypropylene Sink

Where specified Sink provided shall be chemical resistant made of Polypropylene. Have good sloping drain for easy drainage of waste water. It shall be easy to maintain hygiene and will easily fit into work top with smooth edges and finish. The Sink shall be a single molded piece including the outlet to avoid leakage (not 2 piece sink which is prone to leakage) and will not have any sharp corners inside. A anti siphon bottle trap in Polypropylene shall be connected directly coupled to the threaded outlet at sink bottom. Sink color shall be black.

5. Water fittings

It shall be made of brass (UNI 5705 -65) and will have an epoxide covering in White color. Fittings shall be manufactured as per modern technologies & comply to DIN 12920 standards for the best performance.

Connection: G3/8, G1/2 and G3/4 UNI ISO 228/1.

Nozzle : olive type hose screw coupling DIN 12898.

Upper part: with normal regulation closing on/off.

Maximum working pressure: 10 Bar.

Sound – control during the flow of the water: DIN 4109. All taps and mixers used in multi-occupancy properties have to comply emitted noise > 30 dB(A). Water standout fittings shall be from Water saver/ Broen/ TOF Italy. All connector fitting used under bench also shall be high quality and closely sealed against any leaks

6. EMERGENCY SHOWER AND EYE WASH

Emergency Shower and eyewash shall be manufactured according to CE – DIN 12 899 – UNI 9608 standards and they will be characterized by high water flow along with a very soft water spout (DIN EN 246 standard). Eye wash shall be equipped with eye protecting rubber cups and anti-dust covers. Emergency shower and Eye wash shall be from Water saver/ Broen/ TOF Italy.

7. BENCH MOUNTED EYE WASH

Emergency eyewash shall be manufactured according to CE – DIN 12 899 – UNI 9608 standards and they will be characterized by high water flow along with a very soft water spout (DIN EN 246 standard). Eye-washer spray heads shall be made using a combination of plastic material associated with a brass body and valve with anti-corrosion epoxy coating. The jet has a flow regulator able to absorb any dangerous pressure overloads from the water mains. In accordance with the DIN EN 15154 standards, the lever shall be activated with a single movement and has a catch to ensure the continuous delivery of water with total freedom of movement of the hands. Eye wash shall be equipped with eye protecting rubber cups and anti-dust covers. Eye wash shall be from Water saver/ Broen/ TOF Italy.

8. REAGENT RACK WITH SERVICE BOX

The reagent rack shall be made of injection moulded ABS material. Aluminium vertical section 92x 42 mm size, extruded from Aluminium Alloy T 6063 grade for strength, Stability & rigidity. The profile ends shall be covered and protected with injection moulded ABS end caps. Vertical section should have groove for knock down assembly of service box and adjustable shelves. Shelves shall be adjustable at any required height with friction technology without any holes. The Fasteners on the Base shall be covered with caps made of ABS for aesthetic and cleanliness. Extruded aluminium front and back runners shall be provided in order to prevent object falling from the shelves. The entire metal parts shall be epoxy powder coated for aesthetics. The Shelves bracket shall be made of minimum 16 gauge thick epoxy coated galvanized iron sheet. 6mm thick wired glass shall be provided on each shelf.

9. Service box

Service shall be fabricated of 18 G thick Galvanized iron sheet. Base shall be welded together with neat, professional MIG weld fillets. For maximum strength, fillets shall be left ungrounded. Service box shall be pre-treated with an iron phosphate multi-stage process that includes a final

sealer and deionized water rinse. The result is excellent adhesion between the metal and the coating. All exposed surfaces are electro statically coated with a thermo setting laboratory grade powder coating

10. Electrical Sockets and switches

Supply shall be standard 6/16 Amp/220 Volt single or double electrical sockets which fully conforms to IS-1293-1988. Flame retardant, UV stabilized, unbreakable polycarbonate casing. Connector of phosphor bronze to provide high conductivity, flexibility and contact pressure. Silver plated (7 microns) brass terminals to reduce heating and improve conductivity. To be Encased in metal pedestal box, for mounting on to bench work tops or on service pillars. Switches shall be Piano type unless otherwise specified. Sockets can be either MK UK, Legrand, or Northwest.

11. CHEMICAL STORAGE

Chemical storage cabinet shall be completely made of Chemical Resistant PP (Polypropylene) sheets. The Door and cabinet body shall be made of 15mm thick Polypropylene Sheets and the back wall of 6mm. All joints are fusion welded. There shall be no exposed part of metal in the cabinet, even the hinges shall be made of polypropylene. A Polypropylene "D" shaped handle shall be fixed on the door.

12. BALANCE BENCH

Fabricated with heavy duty metal tube section of size 100 x 50 x 2mm. Heavy Granite platform of 30 mm thick shall be placed on highly sensitive anti vibration pads independently attached to the frame work. These pads will individually adjustable for precise leveling. The complete bench rests on special vibration dampening, leveling feet in order to install even at unlevelled site conditions. The frame work shall be de-greased and epoxy powder coated with the thickness of minimum 80 - 90 microns for smooth finish and protection.

13. MATERIAL SPECIFICATIONS OF FUME HOOD

The Fume cupboards shall be designed, manufactured and installed and commissioned as per ASHRAE 110 – 1995.

Fume hood's superstructure shall be made from 1.2mm thick galvanized iron sheets. Triangular profiled niche post front housing the U L fittings and all shall be pre-treated with 8 tank chemical processes and powder coated with highly chemical resistant epoxy powder coating. Powder coating shall be minimum dry film thickness of min 70 to 80 microns passing all conformity performance tests as per IS standards. The interior of fume hood has a working dimension of 1540x 670x 1200 and construction including the baffle shall be from chemical & heat resistant, fire retardant, smooth finish, easily cleanable panels made out of electron beam cured phenolic resin material 6 mm thick with an ASTM flame spread index < 25 and No other material is accepted. Bed of 1540 x 700 highly

chemical resistant splash & spillage proof dished 25 mm thick epoxy (Make Durcon USA). No other material is accepted. Support frames shall be GI steel tubes 40 x 40 x 2 mm thick and overall frame shall be 1825 x 900 x 2400. Vertical rising sash shall be counter-balanced with pulley and counter-weight system for smooth operation. Thickness of toughened float glass shall be of minimum 6 mm. Clear open able height shall be 750 mm. Ports which are open-able apex board for easy maintenance of tube light and flow control valve and Side rim board for utility valves and tubing to be provided. Two no's electrical International Universal type board with rocker switch and sockets (220 V, 6/16 A, 50 Hz) to be provided on the right outside board and two nos. 18W, LED tube lighting shall be provided in a separate protective sealed chamber inside the fume hood at the summit of the work top. Unique exhaust port design should ensure that the fumes shall be exhausted smoothly without any turbulence at the exhaust port and is connected to an appropriately sized high quality extract fan with PVC ducting. Blower and motor shall be Plastifier Italy VSB 30, which can provide trouble free operation for several years without any maintenance. Motor is of 1.1kW, three phase, 380/440V and 1450 rpm, with a range of 1300 to 4000 m³/h. Blower housing is of strong high density UV treated polypropylene for maximum corrosion resistance and the high performance impeller with forward curved blades static and dynamically balanced is completely made of 100% polypropylene with noise level less than 62 db. The performance is tested in house accordance with AMCA 210-85 and ISO 5801. The motor shall be connected with a manual damper. No other make of blower is accepted. The electrical wiring should have a sleek and small built-in DOL starter of Sneider or Telemecanique suitable to the blower motor capacity. All Internal wiring and external wiring shall be from appropriate fire retardant wires from Polycab, V guard, Havells. Level adjusting screws made of S.S Bolts to adjust the fume hood level by + 10 mm to be provided. The Entire ducting works shall be conducted by the fume hood vendor and shall be done with 10 inch Pvc ducting c/w all elbows, reducers, joints and should have rain guard and other accessories including the weather housing for the blower to make the entire system work properly.

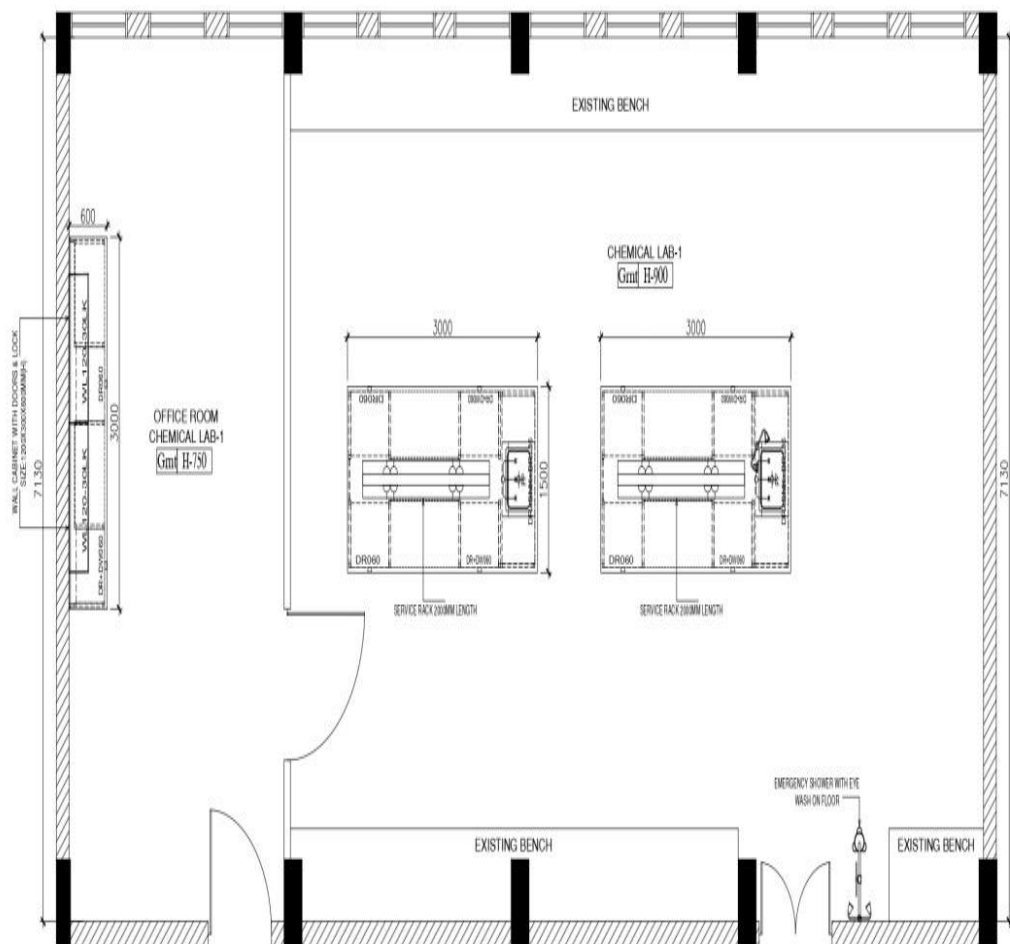

CIFT-FOOD PROCESSING LAB

Online Bid Submission Details

Online Bid Submission:

The Online bids (complete in all respect) must be uploaded online in Two Covers as explained below:-

<u>COVER - I</u>			
(Following documents to be provided as PDF file)			
S.No.	Documents	Content	File Types
1.	Technical Bid	Make, Model No., Specification, Warranty etc. of the item quoted in the letterhead with its supporting documents.	.PDF
2.		Full Address/contact details, Copy of GST Registration, Income Tax PAN in case of Indian Agents quoting for foreign PEM.	.PDF
3.		Bid security declaration sign and stamp of the bidder	.PDF
4.		Self-declaration in letter head that the bidder is the Prime Equipment Manufacturer (PEM), Authorized Dealership license issued from the Prime Equipment Manufacturer (PEM), in case of dealers, Users list.	.PDF
5.		Details of technical support and servicing facility available locally and nationally	.PDF
<u>COVER - II</u>			
S.No.	Types	Content	
1.	Financial Bid	Price bid (BOQ) to be filled in Excel format as per instructions given in price bid	.xls

All the documents and BOQ has to be digitally signed by the bidder.

**Asst. Admn. Officer (P)
For Director**